

Dukkaboard[®]
AQUA 77

Dukkaboard[®]
AQUA 77

GUIDE TO DUKKABOARD AQUA 77



Dukkaboard
Telephone 08701 271300
support@dukkaboard.com
www.dukkaboard.com

©Dukkaboard 2013
Issue DK1 11.13
E & OE

Dukkaboard®

AQUA 77

For a totally waterproof solution, choose Dukkaboard tile backer boards and **Dukkaboard Aqua 77**.

Totally waterproof Aqua 77 is ideal for bathrooms, showers, wet rooms and is suitable for exterior use.

Aqua 77 is an eco-friendly, organic, water-based, mineral waterproofing product for absorbent substrates in damp environments, ideal for use in sustainable building. Single-component with very low volatile organic compound emissions. Safeguards the health of both operators and the environment.

Aqua 77 develops total water-resistance under positive thrust guaranteeing the protection of absorbent substrates or those subject to damp, or constantly humid environments.

- Suitable for subsequent laying of ceramic tiles, porcelain tiles and natural stone using mineral adhesives
- High elasticity and chemical stability
- It colours substrates when applied, making it easy to check correct application
- Solvent-free
- It can be easily applied with a spreader or roller to any substrate



How to **waterproof** Dukkaboard

Dukkaboard and Dukkaboard Aqua 77 create the ultimate waterproofing system, for total peace of mind.

The area needing to be tanked in a bathroom with a shower attachment consists of:

- the total floor area
- the wall to ceiling height around the bath, plus 50cm
- a 10cm upstand all the way round the walls. **See fig 1.**

The area needing to be tanked in a shower consists of:

- the total floor area
- the bottom 10cm of walls
- the area inside the shower enclosure, which should be covered up to the ceiling. **See fig 2.**

If a shower attachment is fitted, the area around the basin should be treated from the floor upwards with a 50cm margin above and beside. Again, the whole floor should be treated as a wet zone whether the shower is fitted or not, with a 10cm upstand all the way round the walls. **See fig 3.**

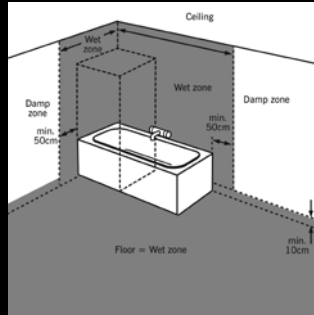

fig 1

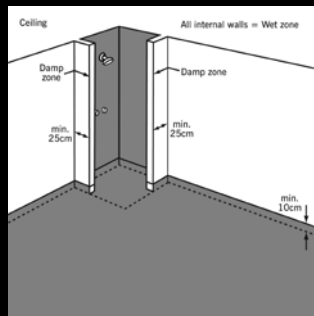

fig 2

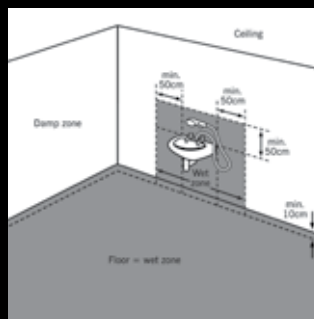

fig 3

How to **waterproof** Dukkaboard walls

Walls

When using Dukkaboard for walls, the boards do not need to be primed, follows steps 2-4.

1 All absorbent surfaces such as plasterboard, fibreboard and brickwork should be primed with one coat of Neo-Flex used concentrated or diluted with water 1:3, depending on porosity of substrate.

2 Firstly cover all joints, edges and corners with 10cm wide Fleece+ strips. **See fig 1.**

3 Using a brush or roller, apply a minimum of 1mm (1.25 kg/m²) Neo-Flex to the surface. If applying in two stages the first coat must be dry before the next is applied. **See fig 2.**

4 The drying time for the waterproofing will depend on the room temperature and humidity. As a guide, allow approximately 12 hours for the Neo-Flex to dry.

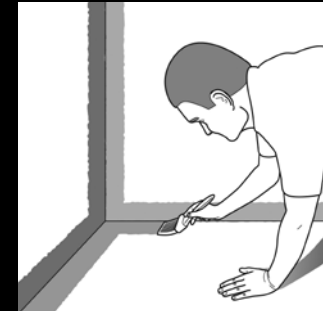

fig 1



fig 2

How to **waterproof** Dukkaboard floors

Floors

When using Dukkaboard for floors, the boards do not need to be primed, follows steps 2-4 below.

1 Prime cement-based and absorbent surfaces with one coat of Pro-Tile Primer diluted with water 1:3. Wooden surfaces should be primed undiluted.

2 Coat the floor using a brush or roller with Neo-Flex and simultaneously cover with Fleece+, rolling the material into the wet Neo-Flex ensuring an overlap on each run of at least 100mm.

See fig 1.

3 A second coat of Neo-Flex should be applied immediately to the Fleece+ making sure that the material is fully covered and saturated. To check for complete waterproofing of the surface ensure that no trace of the white Fleece+ is visible. **See fig 2.**

4 Allow approximately 12 hours for the Neo-Flex to dry before any further work is carried out. When completely dry the surface is ready to tile.

When used in conjunction with an underfloor heating system, always ensure that the underfloor heating is installed on top of the waterproof membrane.

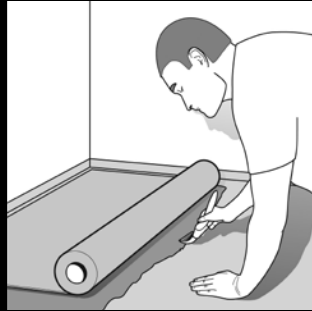

fig 1



fig 2

How to **waterproof** Dukkaboard channel drains

Channel Drains

Complete the following steps in quick succession:

1 Cut four lengths of Aqua 77 Fleece+ (stock no 5488) to size and ensure it covers screw heads on all sides.

See fig 1 and fig 2.

2 Ensure Channel Drain frame is fixed securely and clean from grease, water and dirt. Apply Neo-Flex liberally with a paintbrush to the flange (not the upstand) and at least 100mm of the surrounding Dukkaboard. **See fig 3.**

3 Apply the cut lengths of Aqua 77 Fleece+ over the wet Neo-Flex and press into place. Apply more Neo-Flex to the ends of each length of tape before overlapping with the next. **See fig 4.**

4 Apply Neo-Flex immediately over the tape overlapping onto the Dukkaboard and ensure that all screwheads are covered fully and there are no creases or folds in the tape. **See fig 5.**

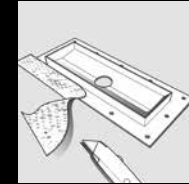

fig 1

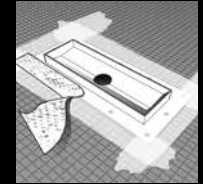

fig 4

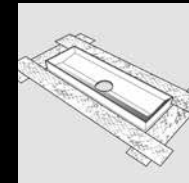

fig 2

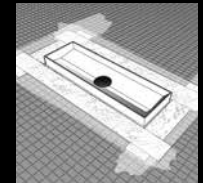

fig 5

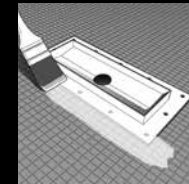

fig 3

How to **waterproof** Dukkaboard pipes

Pipes

Complete the following steps in quick succession:

- 1 Using the Fleece+ manchet 5465 or 5470 (depending on the size of pipe), cut a hole out of the middle. **See fig 1.**
- 2 This should be slightly smaller than the diameter of the pipe. **See fig 2.**
- 3 Expose the self-adhesive backing, taking care not to let the manchet stick to itself. **See fig 3.**
- 4 Push over the pipe and onto the Dukkaboard. **See fig 4.**
- 5 Make sure it is properly stuck to the board. **See fig 5.**
- 6 Apply a coat of Neo-Flex to the manchet and let dry. This will create a seal around the pipe. **See fig 6.**



Neo-Flex / Fleece+



fig 4



before installation

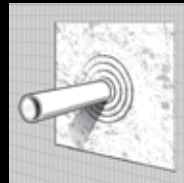

fig 5



fig 1



fig 6



fig 2

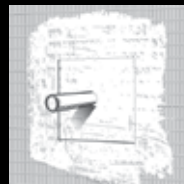

after installation

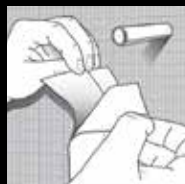

fig 3

How to **waterproof** Dukkaboard joints

Joints

Complete the following steps in quick succession:

- 1 Apply the Neo-Flex to the surface of the boards with a paint brush or roller. **See fig 1.**
- 2 Stick the Fleece+ strip onto the wet Neo-Flex making sure it is thoroughly adhered to the surface. **See fig 2.**
- 3 Paint a coat of Neo-Flex onto the Fleece+ using a brush or roller to smooth out any creases. **See fig 3.**
- 4 Leave to dry before tiling. **See fig 4.**



Neo-Flex / Fleece+

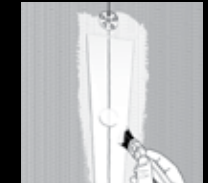

fig 3



fig 1



fig 4



fig 2

How to **waterproof** Dukkaboard washers

Washers

Complete the following steps in quick succession:

- 1 Apply a coat of Neo-Flex to the fixing washer. **See fig 1.**
- 2 Apply Neo-Flex to the surrounding area using a brush or roller. **See fig 2.**
- 3 Cut a piece of Fleece+ from a 10cm wide strip to create a square. **See fig 3.**
- 4 Press the Fleece+ onto the wet Neo-Flex using the brush or roller and push into position and smooth out if necessary. **See fig 4.**
- 5 Paint a coat of Neo-Flex over the top to create a waterproof seal and leave to dry. **See fig 5.**



Neo-Flex / Fleece+



fig 3

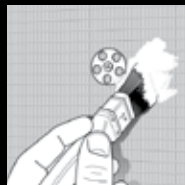

fig 1

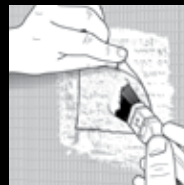

fig 4



fig 2

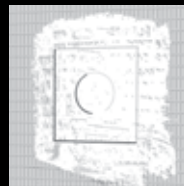

fig 5

How to **waterproof** Dukkaboard corners

Corners

The following procedure should be carried out in quick succession:

- 1 Apply the Neo-Flex to the floor/wall joint with a brush or small roller, making sure the surface covered is at least 25mm wider than the Fleece+. **See fig 1.**
- 2 Lay the Fleece+ onto the wet Neo-Flex. Push the Fleece+ well into the corner and overlap it equally onto the wall and floor. Then reapply Neo-Flex. **See fig 2.**
- 3 To wrap the Fleece+ around an internal corner, cut through to the middle of the material at exactly the right position. **See fig 3.**
- 4 Press the Fleece+ onto the wet Neo-Flex, keeping the section for the floor off the surface. **See fig 4.**
- 5 Re-coat this section with Neo-Flex and then stick the Fleece+ to the floor. **See fig 5.**
- 6 Re-coat the Fleece+ with another coat of Neo-Flex and leave to dry. **See fig 6.**
- 7 Coat the vertical joints with Neo-Flex. **See fig 7.**
- 8 Apply the Fleece+ to the area, pushing it well into the joint and making sure it doesn't quite meet the floor. **See fig 8.**
- 9 Re-coat the Fleece+ with another coat of Neo-Flex. **See fig 9.**



Neo-Flex / Fleece+



fig 5

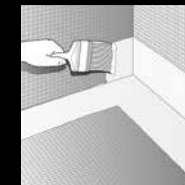

fig 1

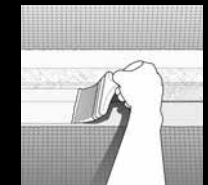

fig 6

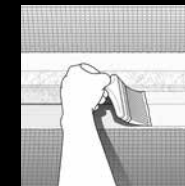

fig 2

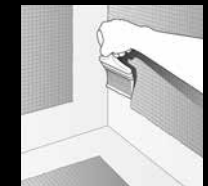

fig 7



fig 3

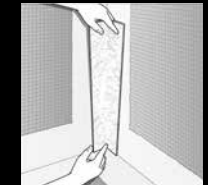

fig 8

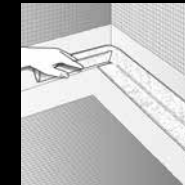

fig 4

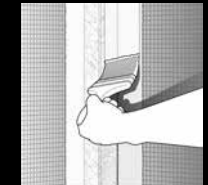

fig 9

Dukkaboard Aqua 77 range

SOLVENT FREE, CHEMICAL STABILITY

HIGH ELASTICITY, LOW VOC EMISSIONS

EASY TO APPLY

An organic, water-based, eco-friendly, mineral waterproofing product for absorbent substrates in damp environments, ideal for use in sustainable building.

Single-component with very low volatile organic compound emissions. Safeguards the health of both operators and the environment.

Neo-Flex provides total water-resistance under positive thrust, guaranteeing the protection of absorbent substrates or those subject to damp, or constantly humid environments.



SOLVENT FREE, BINDS DUST

SUITABLE FOR HEATED SUBSTRATES

Eco-friendly, water-based surface isolation product for dry, absorbent mineral, cement, gypsum or anhydrite-based substrates.

Single-component, with very low volatile organic compound emissions. Safeguards the health of both operators and the environment.

Dukkaboard Aqua 77 Pro-Tile Primer develops an isolating, cohesive film which neutralizes the expansive chemical reaction of gypsum or anhydrite-based substrates in contact with mineral mortars and adhesives. Reduces and regulates the absorption of highly porous substrates.



Dukkaboard Aqua 77 range

FLEXIBLE MEMBRANE, TENSION RESISTANT

OPEN FIBRE STRUCTURE ALLOWS ABSORPTION OF DUKKABOARD AQUA 77 NEO-FLEX

Dukkaboard Aqua 77 Fleece+ is an artificial fibre matting used as a carrying layer for Dukkaboard Aqua 77 Neo-Flex.

Dukkaboard Aqua 77 Fleece+ creates an effective waterproof layer in wall corners, connections between the floor and wall, joints between panels, pipe or balustrade junctions, bathroom outlets etc.

At 100mm wide, Dukkaboard Aqua 77 Fleece+ is easy to use and provides fast covering, totally waterproof joints.



FLEXIBLE MEMBRANE, TENSION RESISTANT

OPEN FIBRE STRUCTURE ALLOWS ABSORPTION OF DUKKABOARD AQUA 77 NEO-FLEX

Dukkaboard Aqua 77 Fleece+ is an artificial fibre matting used as a carrying layer for Dukkaboard Aqua 77 Neo-Flex.

Dukkaboard Aqua 77 Fleece+ creates an effective waterproof layer in wall corners, connections between the floor and wall, joints between panels, pipe or balustrade junctions, bathroom outlets etc.

At 100cm wide, Dukkaboard Aqua 77 Fleece+ is easy to use and provides fast covering, totally waterproof joints.



Dukkaboard®

AQUA 77

For more information on the Dukkaboard Aqua 77 range, please contact our customer services team on 08701 271300 or visit our website

www.dukkaboard.com



When installed in accordance with the manufacturer's guidelines and correctly fixed / adhered to a suitable, stable and durable background, Dukkaboard is fully guaranteed for 25 years.